



MTN/1109C Series

General purpose industrial accelerometer
Cost effective equivalent to other commercially available products

Applications

- Data-collector
- Heavy industry
- Paper machinery

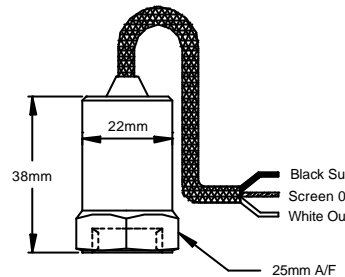

Technical Specification

| | |
|------------------------|---|
| Sensitivity | 100 mV/g $\pm 10\%$ nominal at 80 Hz |
| Frequency Response | 2 Hz to 8 kHz $\pm 10\%$ (-3 dB at 0.8 Hz) |
| Mounted Base Resonance | 18 kHz (nominal) |
| Isolation | Base isolated |
| Transverse Sensitivity | Less than 5% |
| Electrical Noise | 0.1 mg max |
| Supply Voltage | -24 Volts DC |
| Bias Voltage | -12 Volts DC nominal |
| Temperature Range | -55°C to 140°C |
| Case Material | Stainless steel |
| Range | $\pm 80g$ |
| Cable | Integral stainless steel overbraided PTFE |
| Standard Cable Length | 5 metres |
| Maximum Cable Length | 1000 metres |
| Mounting Torque | 8 Nm |
| Weight | 110 gms (nominal) |
| Sealing | IP67 |
| Options | Intrinsically safe, connector, cable length, various mounts |

| Order Code Part No | Mounting |
|--------------------|---------------------|
| MTN/1109C | 1/4" UNF Female |
| MTN/1109CM | M10 x 8mm Male |
| MTN/1109CM8 | M8 x 8mm Male |
| MTN/1109CMI | 1/4" UNF x 6mm Male |
| MTN/1109CQ | Quick Fit Female |
| MTN/1109CF8 | M8 Female |

Mounting Adapters and Studs

Studs and Grub Screws

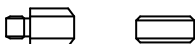

| Male Studs | | |
|--------------|---------------|---------------|
| Product Code | From | To |
| MS036 | 1/4" - 28 UNF | M6 |
| MS039 | 1/4" - 28 UNF | 10 - 32 UNF |
| MS067 | 1/4" - 28 UNF | M8 |
| MS068 | 1/4" - 28 UNF | 1/4" - 28 UNF |
| MS124 | 1/4" - 28 UNF | M10 |
| MS132 | 1/4" - 28 UNF | M12 |

Quick Fit Adapters

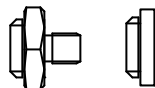

| Quick Fit (Q/F) | | |
|-----------------|----------|--------------------|
| Product Code | From | To |
| MS001 | Q/F Male | Glue Base |
| MS002 | Q/F Male | M8 Male |
| MS003 | Q/F Male | M10 Male |
| MS004 | Q/F Male | 1/4" - 28 UNF Male |
| MS006 | Q/F Male | M6 Male |

Other Adapters

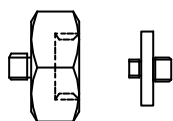

| Mounting Adapters | | |
|-------------------|--------------------|----------------------|
| Product Code | From | To |
| MS005 | Q/F Male | 1/4" - 28 UNF Female |
| MS007 | Q/F Male | 10 - 32 UNF Female |
| MS008 | Q/F Male | M8 Female |
| MS011 | 1/4" - 28 UNF Male | Q/F Female |
| MS013 | 1/4" - 28 UNF Male | Glue Base |
| MS033 | 1/4" - 28 UNF Male | Q/F Female |
| MS038 | Q/F Male | M8 Conical Male |
| MS061 | 1/4" - 28 UNF Male | 10 - 32 UNF Male |
| MS079 | 1/4" - 28 UNF Male | Q/F Female |
| MS106 | Q/F Male | M10 Female |

| Isolation | | |
|--------------|--------------------|----------------------|
| Product Code | From | To |
| MS034 | 1/4" - 28 UNF Male | 1/4" - 28 UNF Female |
| MS093 | Q/F Male | M8 Male |

System Connection

