

MTN/1100IW 

Intrinsically Safe Industrial Accelerometer

ATEX & IECEx Group II Approved

Not to be mounted in a high velocity dust laden atmosphere

Applications

- Submersible Pumps
- Roll Monitors
- Paper Machinery

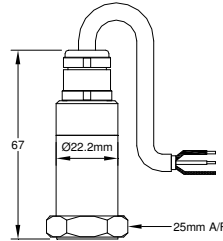

Technical Specification

Standard Sensitivity	100 mV/g ±10% Nominal at 80 Hz
Frequency Response	2 Hz to 10 kHz ±5% (-3 dB at 0.8 Hz)
Mounted Base Resonance	18 kHz (nominal)
Isolation	Base isolated
Transverse Sensitivity	Less than 5%
Electrical Noise	0.1 mg max
Current Range	0.5 mA to 8 mA
Bias Voltage	12 Volts DC (nominal)
Operating Temperature Range	-25 to +90 °C
Case Material	Stainless steel
Cable Type	Integral Polyurethane Cable.

Warning ref Group II: This cable has additional hosing around it manufactured from PTFE plastic, which has a surface resistivity of greater than 1 Gohm and therefore poses a risk from electrostatic ignition. Care should be taken not to install the cable in a high velocity, dust laden atmosphere

Submersible Depth	100 metres maximum (10 bar)
Weight	150 gms (nominal)
Sealing	IP68
Mounting Torque	8Nm
Maximum Cable Length	See system drawing ATX028
Certificate Details: Group II	BAS02ATEX1057X and IECEx BAS 08.0013X Ex11 1GD T85°C Ex ia IIC T6 (-55°C ≤ Ta ≤ +65°C) Ex iaD 20 T85°C (-55°C ≤ Ta ≤ +65°C)

Warning ref Group II: The Ci and Li were previously lower. The installer must take account of the increase in internal capacitance and inductance present on this apparatus

System Connection	Drawing ATX028
Terminal Parameters	Ui = 28V, li = 93mA, Pi = 0.65W see
500V Isolation	Units will pass a 500V isolation test
Barrier	1 x MTL7728+ (BAS01ATEX7217) or P&F Z728 (BAS01ATEX7005) or any other barrier that conforms to note 5 of ATX028

Monitran Ltd

Monitor House | 33 Hazlemere Road | Penn | Bucks | HP10 8AD | UK

Tel: +44 (0)1494 816569

Email: info@monitran.com

Registered in England No. 2054040

Fax: +44 (0)1494 812256

Web: www.monitran.com

Vat No. GB442 4883 40

Mounting and Sensitivity

ORDER CODE PART No	MOUNTING	xx = OPTIONAL SENSITIVITY RANGE AVAILABLE (+/- 10%)
MTN/1100IW-xx MTN/1100IWQ-xx	1/4" UNF FEMALE QUICK FIT FEMALE	10 mV/g 25 mV/g 30 mV/g 50 mV/g
FOR OTHER MOUNTINGS SEE BELOW.		

Options	Connector, Various cable lengths, Optional mounting, other sensitivities (see table).
----------------	---

Mounting Adapters and Studs

Studs and Grub Screws



Male Studs		
Product Code	From	To
MS036	1/4" - 28 UNF	M6
MS039	1/4" - 28 UNF	10 - 32 UNF
MS067	1/4" - 28 UNF	M8
MS068	1/4" - 28 UNF	1/4" - 28 UNF
MS124	1/4" - 28 UNF	M10
MS132	1/4" - 28 UNF	M12

Quick Fit Adapters

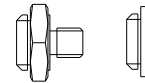

Quick Fit (Q/F)		
Product Code	From	To
MS001	Q/F Male	Glue Base
MS002	Q/F Male	M8 Male
MS003	Q/F Male	M10 Male
MS004	Q/F Male	1/4" - 28 UNF Male
MS006	Q/F Male	M6 Male

Monitran Ltd

Monitor House | 33 Hazlemere Road | Penn | Bucks | HP10 8AD | UK

Tel: +44 (0)1494 816569 Email: info@monitran.com Registered in England No. 2054040

Fax: +44 (0)1494 812256 Web: www.monitran.com Vat No. GB442 4883 40



Other Adapters

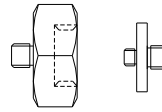

Mounting Adapters		
Product Code	From	To
MS005	Q/F Male	1/4" - 28 UNF Female
MS007	Q/F Male	10 - 32 UNF Female
MS008	Q/F Male	M8 Female
MS011	1/4" - 28 UNF Male	Q/F Female
MS013	1/4" - 28 UNF Male	Glue Base
MS033	1/4" - 28 UNF Male	Q/F Female
MS038	Q/F Male	M8 Conical Male
MS061	1/4" - 28 UNF Male	10 - 32 UNF Male
MS079	1/4" - 28 UNF Male	Q/F Female
MS106	Q/F Male	M10 Female

Isolation		
Product Code	From	To
MS034	1/4" - 28 UNF Male	1/4" - 28 UNF Female
MS093	Q/F Male	M8 Male

Measuring System Connection

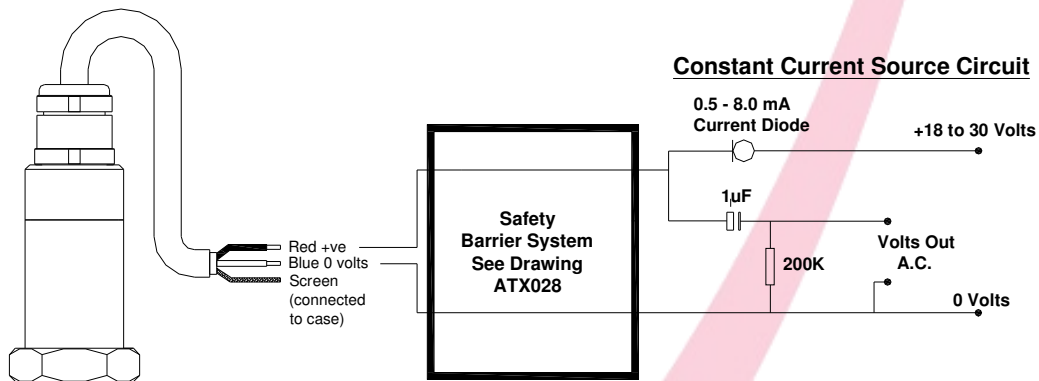

Note : Care should be taken not to install this in a high velocity dust laden atmosphere.

Monitran Ltd

Monitor House | 33 Hazlemere Road | Penn | Bucks | HP10 8AD | UK

Tel: +44 (0)1494 816569

Email: info@monitran.com

Registered in England No. 2054040

Fax: +44 (0)1494 812256

Web: www.monitran.com

Vat No. GB442 4883 40

